

PiPAD™

PiPAD™ Lite
ASM1900152-

Scan the QR code to visit our
installation guides or
www.raspberrypioplastics.com

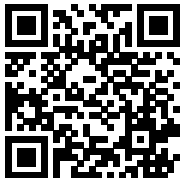

oneninedesign™

Software install:

1. Make sure you have followed the Raspberry Pi foundation's instruction to install the latest OS to your SD card:

[HTTPS://www.raspberrypi.org/software/](https://www.raspberrypi.org/software/)

Once the OS is installed you should confirm it's up to date. To do this Open terminal on Pi and type:

```
sudo apt update
```

This should update your OS to the latest revision. Reboot your Pi.

Once restarted again open terminal and type the following:

```
sudo nano /boot/config.txt
```

Now add the following two lines to the bottom of the config.txt file:

```
dtoverlay=gpio-poweroff,gpiopin=18,active_low=0
dtoverlay=gpio-shutdown,gpio_pin=17,active_low=1,gpio_pull=up
```

Save the file and reboot.

To start your Pi:

Press the STAND-BY button >1 sec.

LED ring goes GREEN

Shut down

Press the STAND-BY button >3 sec.

LED ring flashes RED

Forced Shut down

Press the STAND-BY button >10 sec.

LED ring flashes RED

E-mail: info@oneninedesign.co.uk

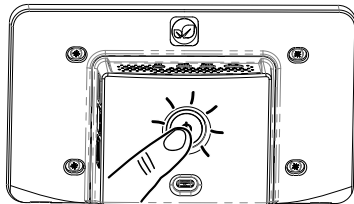

1



<https://www.raspberrypi.org/learning/addons-guide/display/>

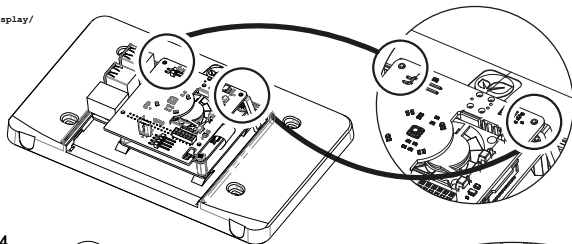
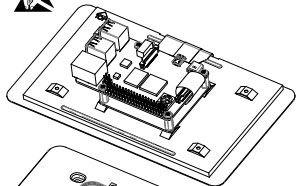

2

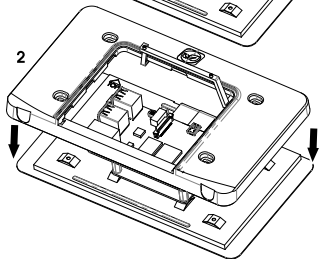

4

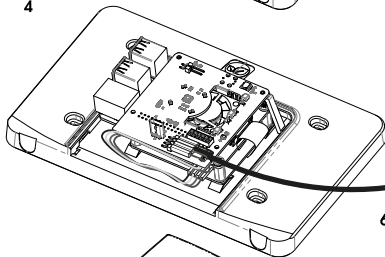

3

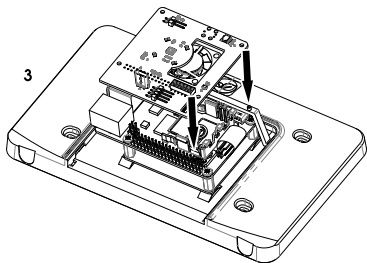

5

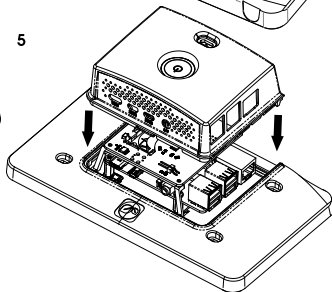

6

